



**FRONTLINE
CONSTRUCTION**

Spinney Close Bathroom Transformation

CASE STUDY

BECKENHAM

2026 COLLECTION





**FRONTLINE
CONSTRUCTION**

CONTENTS

Residential Bathroom Renovation Case Study

- **01** Introduction
- **02** Project Profile
- **03** Before & Design Plans
- **04** Design Visualisation
- **05** Final Reveal
- **06** Client Feedback

01 Introduction

Every project begins with a vision.

This case study explores the journey from initial concept through to completion, highlighting the planning, craftsmanship, and transformation involved in delivering a tailored final result.

Get in touch

 0208 914 7832

 info@frontline-construction.com

 www.frontline-construction.com



FRONTLINE
CONSTRUCTION

02 Project Profile

An introduction to the project, offering context on the work delivered, and the overall journey from start to completion.



LOCATION
Beckenham



PROJECT TYPE
Bathroom Renovation



DURATION
3 weeks



SCOPE OF WORK

- Full strip-out of master ensuite
 - Plumbing and electrical reconfiguration
 - Structural and layout alterations
 - Installation of new sanitaryware and fittings
 - Tiling, waterproofing, and floor finishes
 - Decoration and final detailing
-

03 Before & Designs Plans

BEFORE



DESIGN PLAN

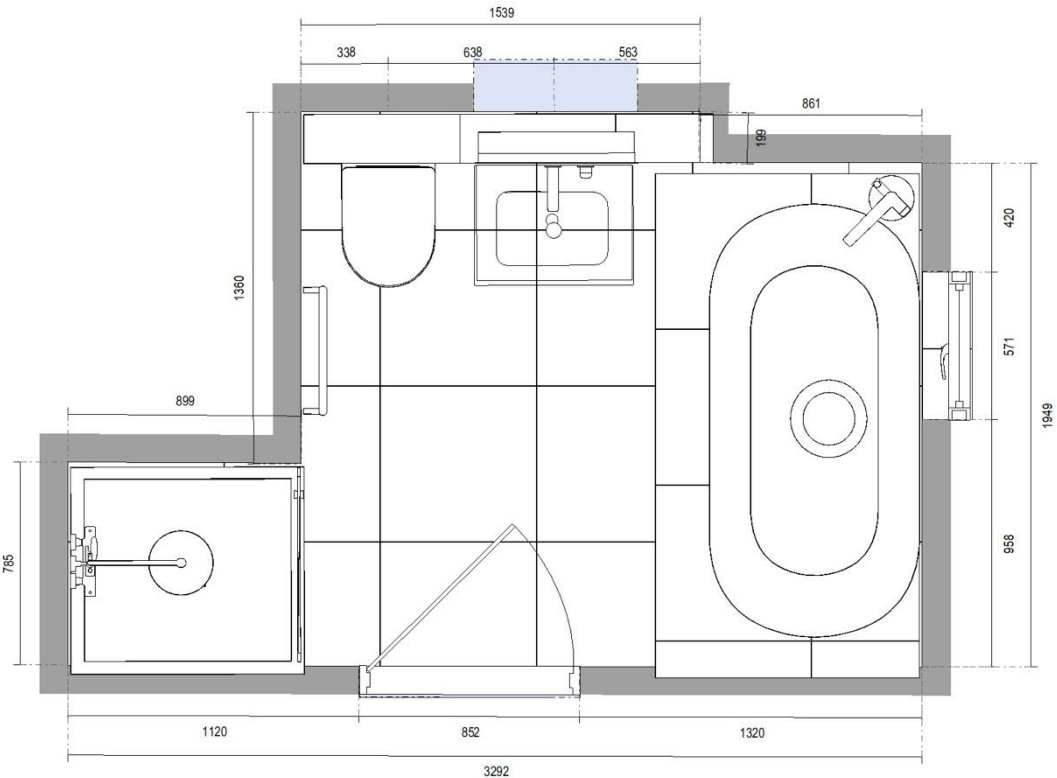

04 Design Visualisation



01 Layout Enhancements

Reconfigured the entire layout to better utilise the available space.



02 Feature Installations

Integrated a free-standing bath with a raised platform.



03 Finishing Specification

Included full wall and floor tiling, bespoke built-in storage and upgraded lighting.

05 Final Reveal



06 Client Feedback



Excellent all-round service. Good communication throughout with detailed plans and advice.

Supportive, confident and calm approach to any concerns or changes required. High standard of work with excellent tidiness and clean-up.

Much appreciated and highly recommended.

-Homeowner, Beckenham

Get in touch



0208 914 7832



info@frontline-construction.com



www.frontline-construction.com



**FRONTLINE
CONSTRUCTION**