



**FRONTLINE  
CONSTRUCTION**

# **Copse Avenue Home Transformation**

**CASE STUDY**

---

**WEST WICKHAM**





**FRONTLINE  
CONSTRUCTION**

# CONTENTS

---

Residential Extension Case Study

- **01** Introduction
- **02** Project Profile
- **03** Before & Design Plans
- **04** Build Process
- **05** Final Reveal
- **06** Client Feedback

# 01 Introduction

---

Every project begins with a vision.

This case study explores the journey from initial concept through to completion, highlighting the planning, craftsmanship, and transformation involved in delivering a tailored final result.

## Get in touch

 0208 914 7832

 [info@frontline-construction.com](mailto:info@frontline-construction.com)

 [www.frontline-construction.com](http://www.frontline-construction.com)



**FRONTLINE**  
CONSTRUCTION

## 02 Project Profile

---

An introduction to the project, offering context on the work delivered, and the overall journey from start to completion.



**LOCATION**  
West Wickham



**PROJECT TYPE**  
Extension



**DURATION**  
6 Months



### SCOPE OF WORK

- Demolition and removal of the existing conservatory
  - Construction of a contemporary single-storey extension
  - Formation of a new open-plan living and dining space
  - Installation of a warm flat room system, underfloor heating and electrics
  - Internal finishes including engineered wood flooring, bespoke carpentry details, plastering, and exterior rendering.
-

# 03 Before & Designs Plans

## BEFORE



## DESIGN PLAN

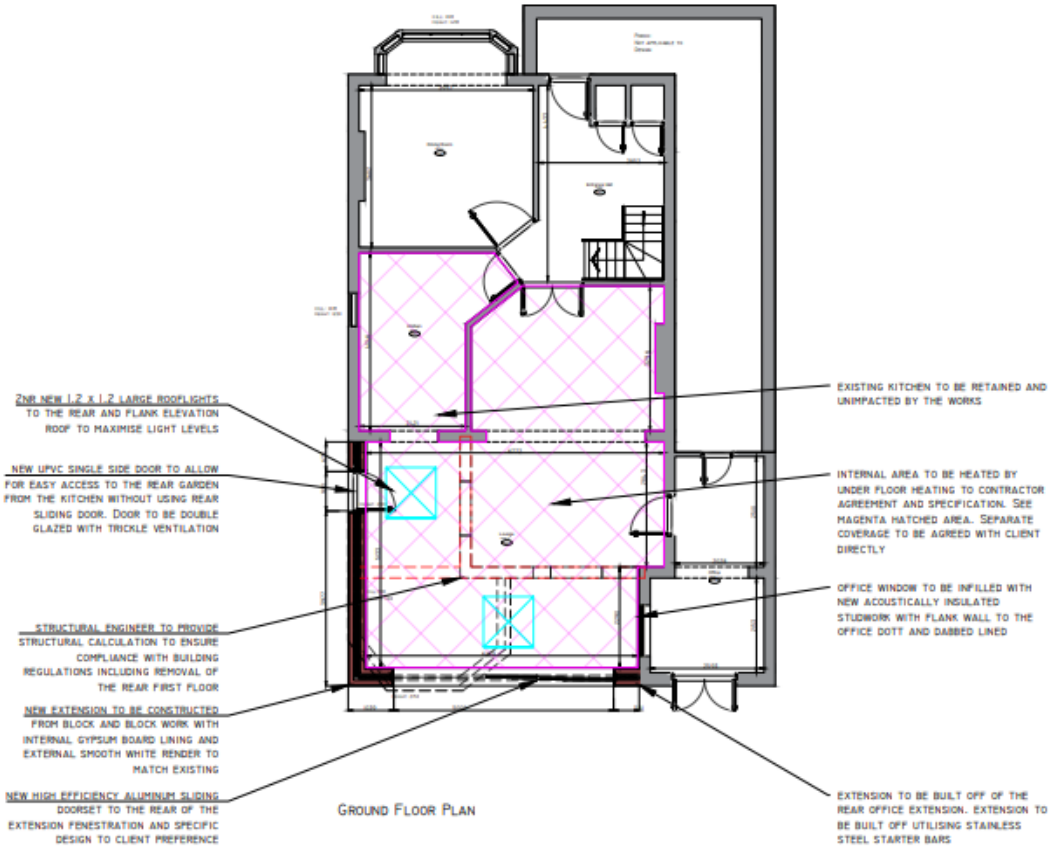

## 04 Build Process

---



- 01 Groundworks**  
Focused on excavation, drainage installation, and preparing the foundations.



- 02 Structural Build**  
New extension walls and structural framework to form the expanded open-plan living area.



- 03 Construction Progress**  
Formation of the external walls, openings and roof structure.

# 05 Final Reveal

---



## 06 Client Feedback

---



Rob, the project manager was very sensitive and considerate to our needs. Communication was excellent throughout and all the workmen, were similarly excellent.

I can't praise them enough. We love our extension. Thank you!

**-Homeowner, West Wickham**

### Get in touch

 0208 914 7832

 [info@frontline-construction.com](mailto:info@frontline-construction.com)

 [www.frontline-construction.com](http://www.frontline-construction.com)



**FRONTLINE  
CONSTRUCTION**